



NOTES FOR INFORMATION:

Borough/Parish Boundary - - - - -

Public Right of Way - - - - -

KEY:

 Land (Title) to be acquired

 New Rights (Easement) to be acquired

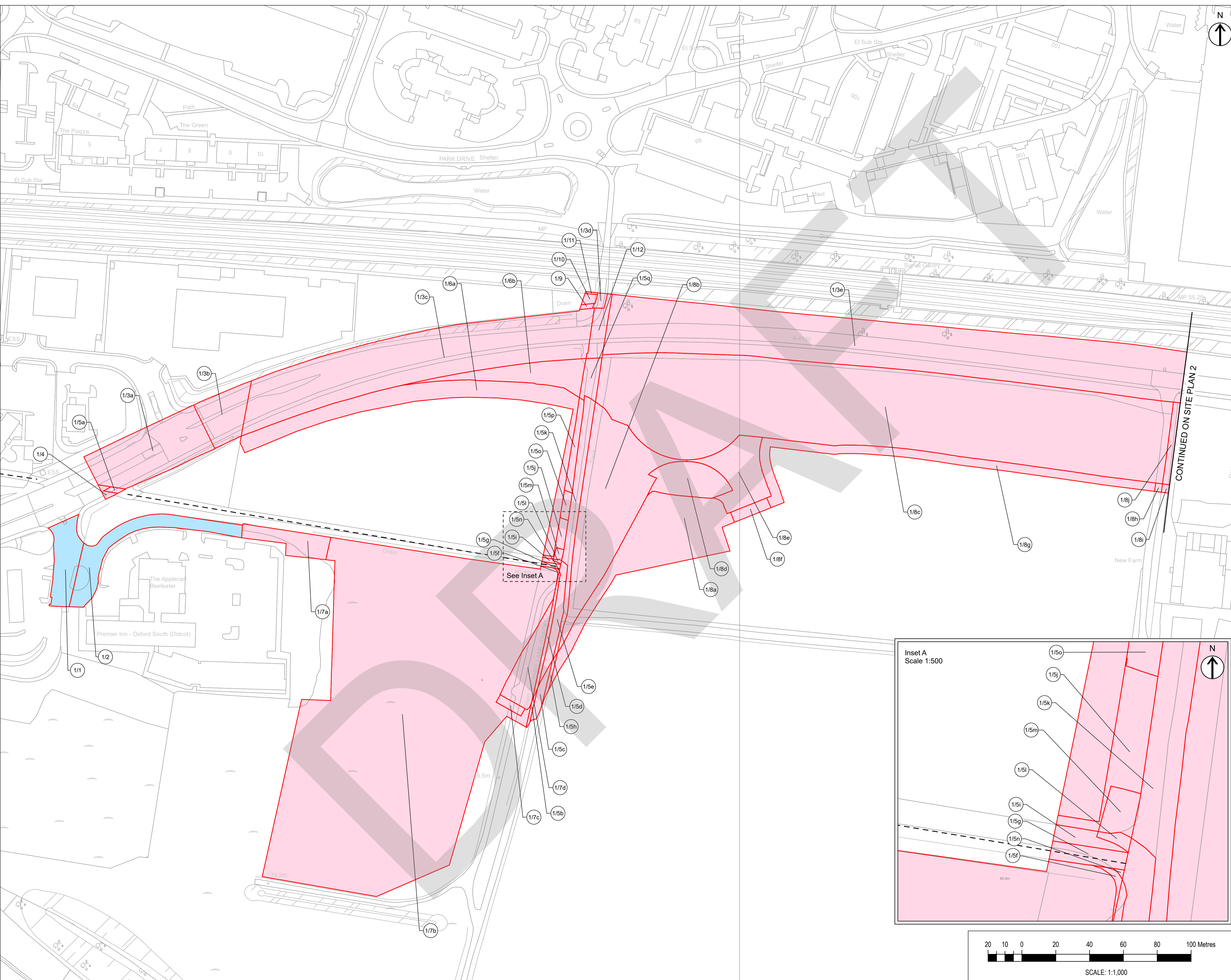

Rev	Description	Date	By	Check	Approved

This map is reproduced from Ordnance Survey material with the permission of Ordnance Survey on behalf of the Controller of Her Majesty's Stationary Office. © Crown Copyright. Unauthorised reproduction infringes Crown Copyright and may lead to prosecution or civil proceedings. Oxfordshire County Council, 010002343, 2021



MAP REFERRED TO IN THE OXFORDSHIRE COUNTY COUNCIL (DIDCOT GARDEN TOWN HIGHWAYS INFRASTRUCTURE – A4130 IMPROVEMENT (MILTON GATE TO COLLETT ROUNDABOUT), A4197 DIDCOT TO CULHAM LINK ROAD, AND A415 CLIFTON HAMPDEN BYPASS) COMPULSORY PURCHASE ORDER 2022

COMPULSORY PURCHASE ORDER
SHEET 1 OF 19
A4130 – MILTON GATE JUNCTION TO NEW FARM

The COMMON SEAL of Oxfordshire County Council was hereto affixed in the presence of –

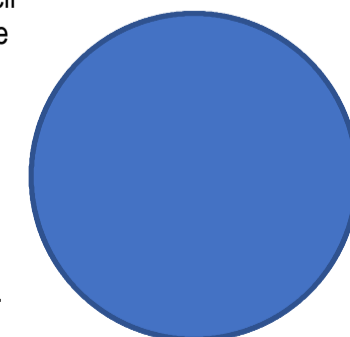

Authorised Officer
Dated this day of 2022 Seal No.

Drawn	Checked	Approved	Date
AH	**	**	06/07/22

GH Project Number	Scale at A1
132861.001	1:1,000
Drawing Number	Revision
GH-132861001-CPO-1	P01.2

